

## Flanged enclosure for modern sensor applications

The new EASYTEC range of wall-mounted enclosures has been optimally designed for the integration of smart sensors for the IIoT (Industrial Internet of Things) and the IoT.

- modern enclosure design with a high degree of stability
- four sizes 80/100/125/150, each in 2 heights
- flame-retardant material ASA+PC-FR and optional protection class IP 65 (seals as accessory) for robust indoor and outdoor applications
- discreet standard off-white colour (RAL 9002) supports the wide range of applications – on request we can also produce the enclosures in other colours
- the bottom part has 2 lugs for quick wall mounting or for installation on pipes/round profiles
- tight electronics compartment with two PCB levels (in the top/bottom parts)
- screw connection with stainless steel screws and Torx drive



# EASYTEC

## Applications and Examples

- IoT/IIoT
- Sensor system
- Environmental technology
- Measurement and control engineering
- Control technology
- Medical and laboratory technology
- Security and monitoring technology
- Information Technology



Automated agriculture



Data logger e.g. for temperature



Data logger with gateway function



Smart store logistics

## Customising Options

What do you still need for your own very personal product? We can supply enclosures and tuning knobs with all necessary modifications for fitting your electronic components.  
Customising options for Easytec



Machining



Lacquering



Printing



Laser marking



EMC shielding



Installation / Assembly  
of accessories

# EASYTEC

## Select Versions



**C3204107**  
EASYTEC 80  
ASA+PC (UL 94 V-0)  
off-white RAL 9002  
101x50x22mm  
IP 65 opt., IP 40



**C3204207**  
EASYTEC 80  
ASA+PC (UL 94 V-0)  
off-white RAL 9002  
101x50x26mm  
IP 65 opt., IP 40



**C3206107**  
EASYTEC 100  
ASA+PC (UL 94 V-0)  
off-white RAL 9002  
121x62x26mm  
IP 65 opt., IP 40



**C3206207**  
EASYTEC 100  
ASA+PC (UL 94 V-0)  
off-white RAL 9002  
121x62x31mm  
IP 65 opt., IP 40



**C3207107**  
EASYTEC 125  
ASA+PC (UL 94 V-0)  
off-white RAL 9002  
147x78x30mm  
IP 65 opt., IP 40



**C3207207**  
EASYTEC 125  
ASA+PC (UL 94 V-0)  
off-white RAL 9002  
147x78x37mm  
IP 65 opt., IP 40



**C3208107**  
EASYTEC 150  
ASA+PC (UL 94 V-0)  
off-white RAL 9002  
172x93x36mm  
IP 65 opt., IP 40



**C3208207**  
EASYTEC 150  
ASA+PC (UL 94 V-0)  
off-white RAL 9002  
172x93x46mm  
IP 65 opt., IP 40

## Accessory "protection"



**A9500030**  
Sealing 80



**A9502030**  
Sealing 100



**A9503030**  
Sealing 125

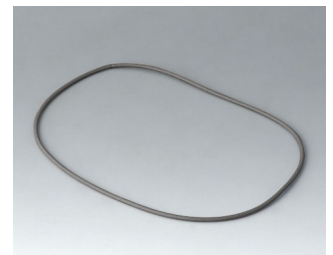

**A9504030**  
Sealing 150

## Accessory "screws"



**A0305031**  
Self-tapping screws 2.5 x 6 mm  
(PZ1)



**A0325060**  
Self-tapping screw 2.5 x 6 mm  
(T8)  
Stainless steel



**A0399T08**  
Torx T8 screwdriver

# EASYTEC

Subject to technical modification without notice. © by OKW Gehäusesysteme, Buchen/Germany.